

DETAIL A
INTERNAL ROADS BUILD-UP

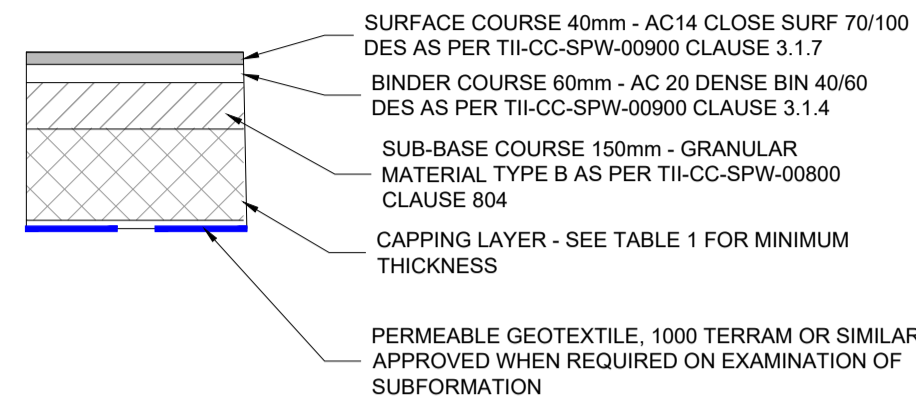

DETAIL B
PERVIOUS PAVING BUILD-UP

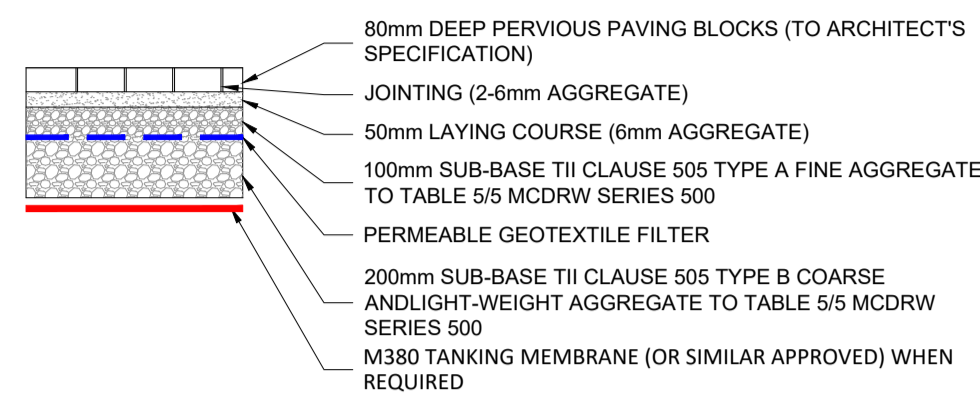

TABLE 1: CAPPING LAYER DEPTH
THE MINIMUM REQUIRED THICKNESS OF NON-FROST SUSCEPTIBLE CAPPING MATERIAL IS SHOWN HEREUNDER:

CBR SUBGRADE (%)	<2.5	2.5	3	4	5-15	>15
THICKNESS OF CAPPING LAYER (mm)	SPECIALIST GEOTECHNICAL ADVISE REQUIRED	600	350	300	250	150

CBR TESTS SHALL BE CARRIED OUT AT A RATE OF ONE TEST PER 100 METERS OF ROAD OR WHERE THE SOIL TYPE CHANGES.

NOTES:

- DO NOT SCALE FROM THIS DRAWING USE STATED DIMENSIONS ONLY. IF IN DOUBT CONSULT THE ENGINEER.
- ALL ROAD WORKS SHALL COMPLY WITH THE ENGINEERS SPECIFICATION AND THE TRANSPORT INFRASTRUCTURE IRELAND SPECIFICATION FOR ROADWORKS.
- TRAFFIC MANAGEMENT SHALL AT A MINIMUM COMPLY WITH DTTAS TRAFFIC SIGNS MANUAL AND THE REQUIREMENTS OF THE RELEVANT LOCAL AUTHORITY, AND BE IN ACCORDANCE WITH THE CONTRACT.
- THIS DRAWING SHALL BE READ IN CONJUNCTION WITH THE SPECIFICATION.
- FOR ROAD LEVELS REFER TO DRAWING B861-OCSC-XX-XX-DR-C-0106.
- ALL EXCAVATIONS BELOW THE ROAD SHOULD BE BACK FILLED WITH CLASS 6F MATERIAL COMPACTED IN ACCORDANCE WITH TABLE 6.4 OF 600 SERIES OF THE SPECIFICATION FOR ROADWORKS (TII).
- GEOTEXTILE TO BE ADDED IF REQUIRED UPON INSPECTION BY ENGINEER.

PLANNING DRAWING.
NOT FOR CONSTRUCTION.
ALL LEVELS GIVEN ARE
RELATIVE TO ORDNANCE DATUM.
THIS DRAWING HAS BEEN ISSUED FOR INFORMATION
PURPOSES ONLY AND MUST NOT BE USED
FOR CONSTRUCTION UNDER ANY CIRCUMSTANCES



CROSS SECTIONS LOCATION
SCALE N.T.S.

DETAIL C
FOOTPATH

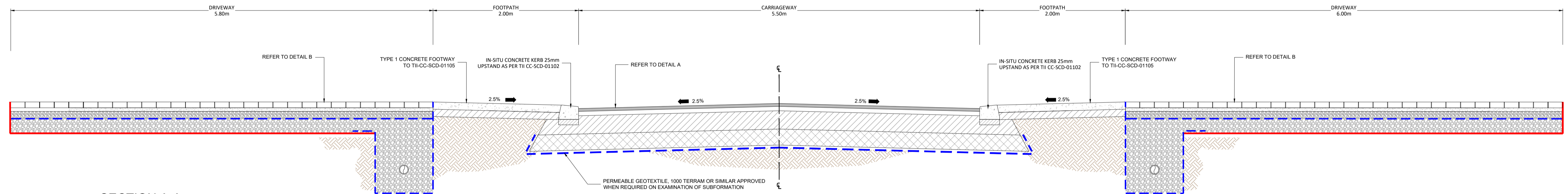
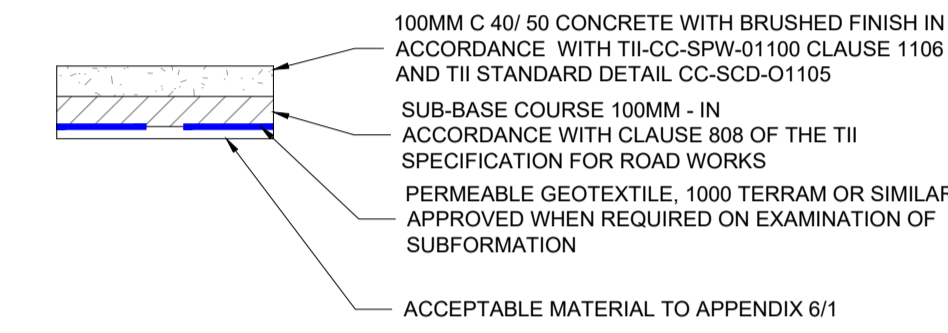

SECTION A-A
SCALE 1:30

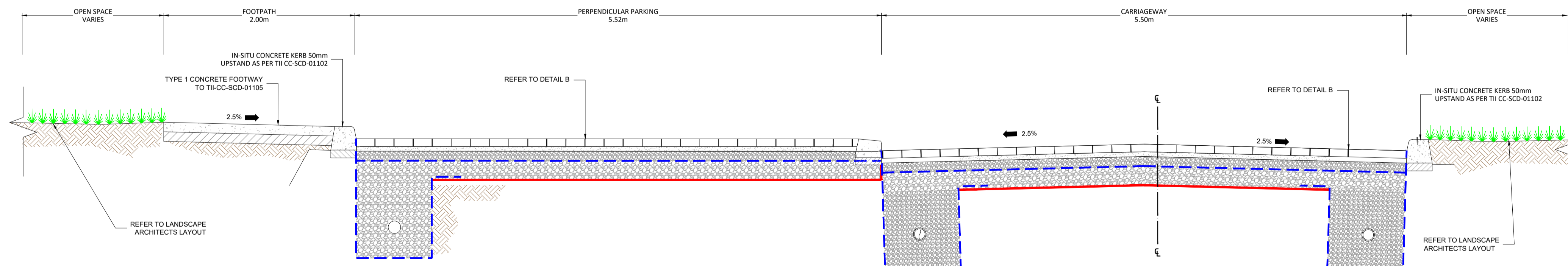

SECTION B-B
SCALE 1:30

ORDNANCE SURVEY OF IRELAND LICENCE NO. EN0000820 © GOVERNMENT OF IRELAND

- FOR SETTING OUT REFER TO ARCHITECT'S DRAWINGS.
- THIS DRAWING TO BE READ IN CONJUNCTION WITH ALL OTHER ARCHITECTURAL AND ENGINEERING DRAWINGS AND ALL OTHER RELEVANT DRAWINGS AND SPECIFICATIONS.
- DO NOT SCALE THIS DRAWING. USE FIGURED DIMENSIONS ONLY.
- NO PART OF THIS DOCUMENT MAY BE REPRODUCED OR TRANSMITTED IN ANY FORM OR STORED IN ANY RETRIEVAL SYSTEM OF ANY NATURE WITHOUT THE WRITTEN PERMISSION OF O'CONNOR SUTTON CRONIN AS COPYRIGHT HOLDER EXCEPT AS AGREED FOR USE ON THE PROJECT FOR WHICH THE DOCUMENT WAS ORIGINALLY ISSUED.

Rev No.	Date	Revision Note	Drn by	Chkd by
C01	26.06.20	ISSUED FOR PLANNING	KP	PG
C02	25.09.20	ISSUED FOR PLANNING	KP	PG

Rev No.	Date	Revision Note	Drn by	Chkd by



Head Office,
9 Prussia Street,
Dublin 7,
D07 KT57

TEL +353 (0)1 8682000

e: contactus@ocsc.ie
w: www.ocsc.ie

Dublin | London | Belfast | Galway | Cork | Birmingham



Client: BURKEWAY HOMES LTD
Project: RESIDENTIAL DEVELOPMENT AT BEARNA

Title: TYPICAL CROSS SECTIONS

Code | Originator | Zone | Level | Type | Role | Number | Status | Revision
B861 · OCSC · XX · XX · DR · C · 0703 | A1 | C02
Date: 26.06.20 Scale: SHWN @ A1 Drn by: KP Chkd by: PG Aprvd by: AH